

SHORTS HALL

FIRST FLOOR

#DukesLiveClose
#DukesLiveSupported
#DukesLIVEON

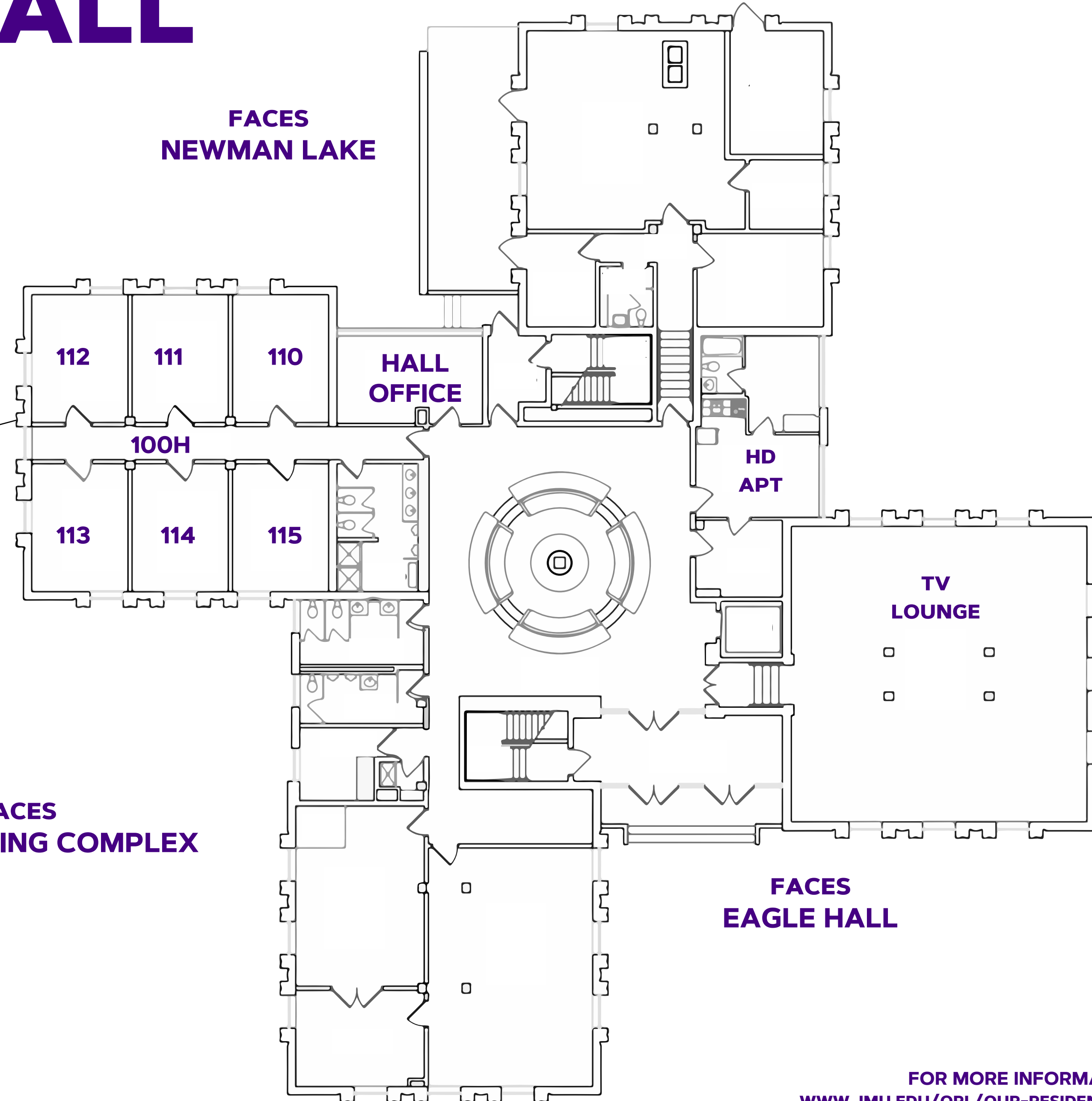

TYPICAL ROOM SPECS
ROOM SIZE: 11'7" X 15'5"
WINDOW SIZE: 4' X 5'9"
CEILING HEIGHT: 8'3"

ROOM FURNITURE:
- BEDS, CHAIRS, DESKS, DRAWERS
- BUILT-IN WARDROBES

UPDATED AS OF 7/9/20

FOR MORE INFORMATION ON HALLS VISIT:
WWW.JMU.EDU/ORL/OUR-RESIDENCE-HALLS/INDEX.SHTML



SHORTS HALL

SECOND FLOOR

#DukesLiveClose
#DukesLiveSupported
#DukesLIVEON

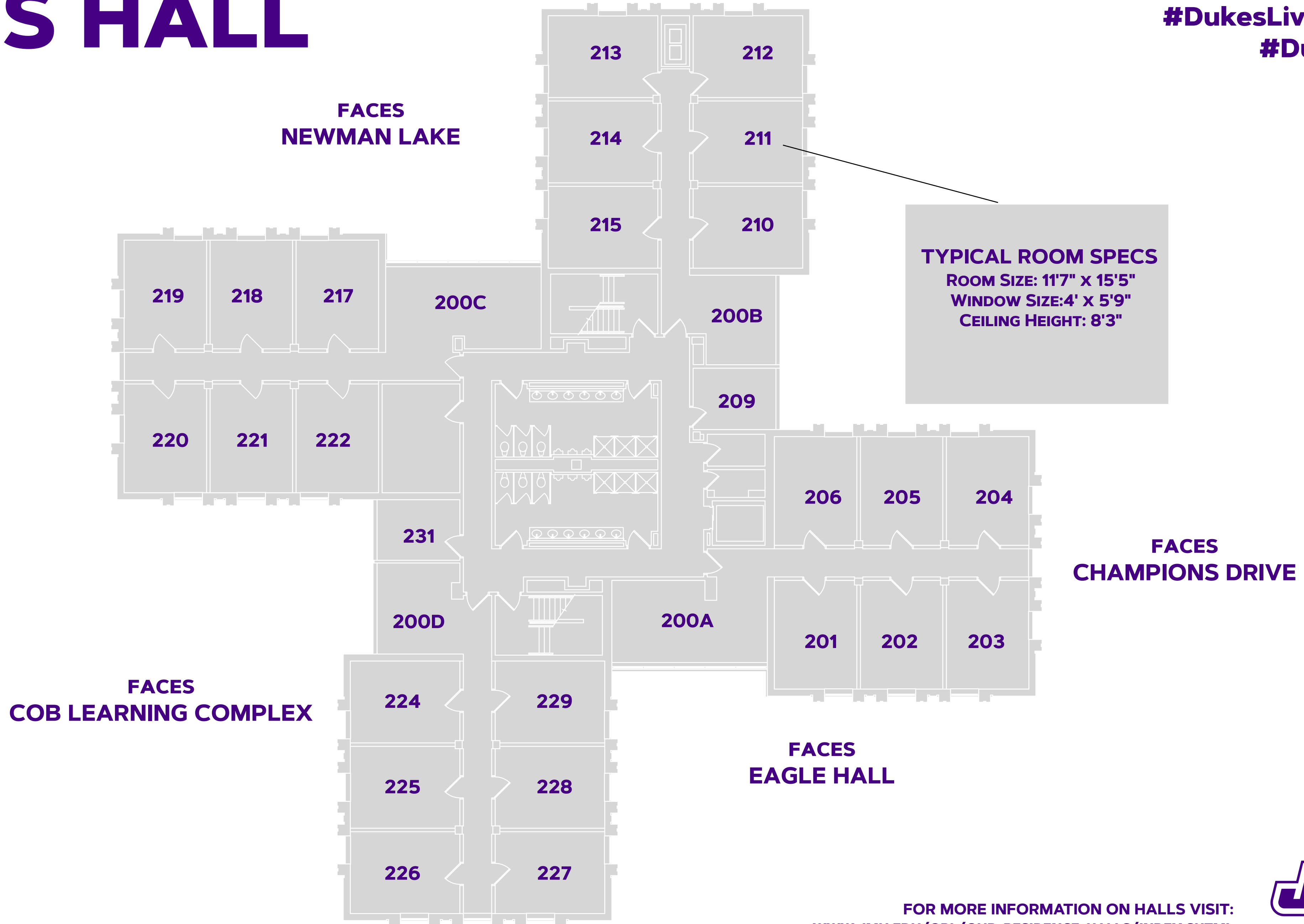

FOR MORE INFORMATION ON HALLS VISIT:
WWW.JMU.EDU/ORL/OUR-RESIDENCE-HALLS/INDEX.SHTML

SHORTS HALL

THIRD FLOOR

#DukesLiveClose
#DukesLiveSupported
#DukesLIVEON

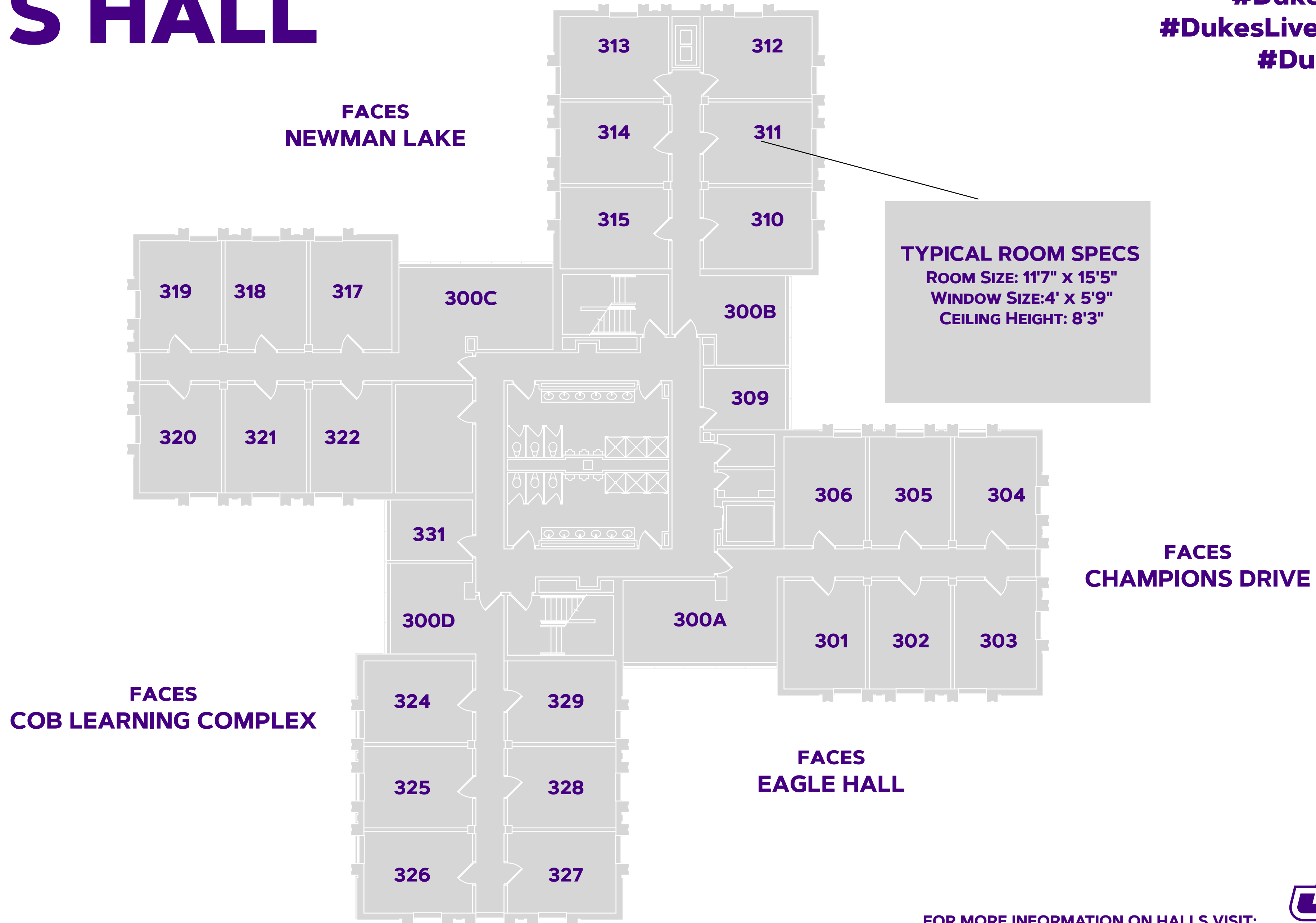

ROOM FURNITURE:
- BEDS, CHAIRS, DESKS, DRAWERS
- BUILT-IN WARDROBES

FOR MORE INFORMATION ON HALLS VISIT:
WWW.JMU.EDU/ORL/OUR-RESIDENCE-HALLS/INDEX.SHTML



SHORTS HALL

FOURTH FLOOR

#DukesLiveClose
#DukesLiveSupported
#DukesLIVEON

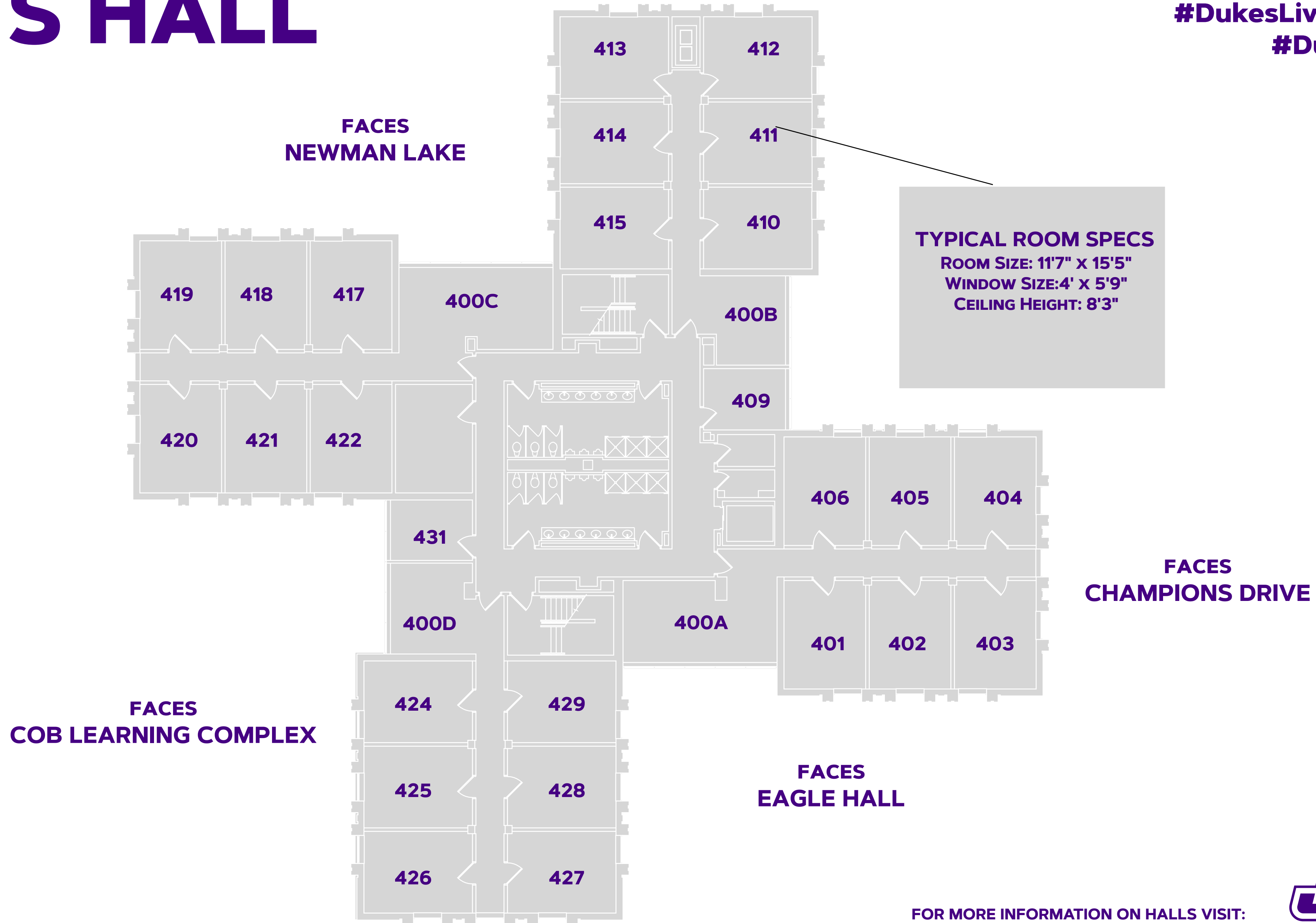

ROOM FURNITURE:
- BEDS, CHAIRS, DESKS, DRAWERS
- BUILT-IN WARDROBES

FOR MORE INFORMATION ON HALLS VISIT:
WWW.JMU.EDU/ORL/OUR-RESIDENCE-HALLS/INDEX.SHTML



SHORTS HALL

FIFTH FLOOR

#DukesLiveClose
#DukesLiveSupported
#DukesLIVEON

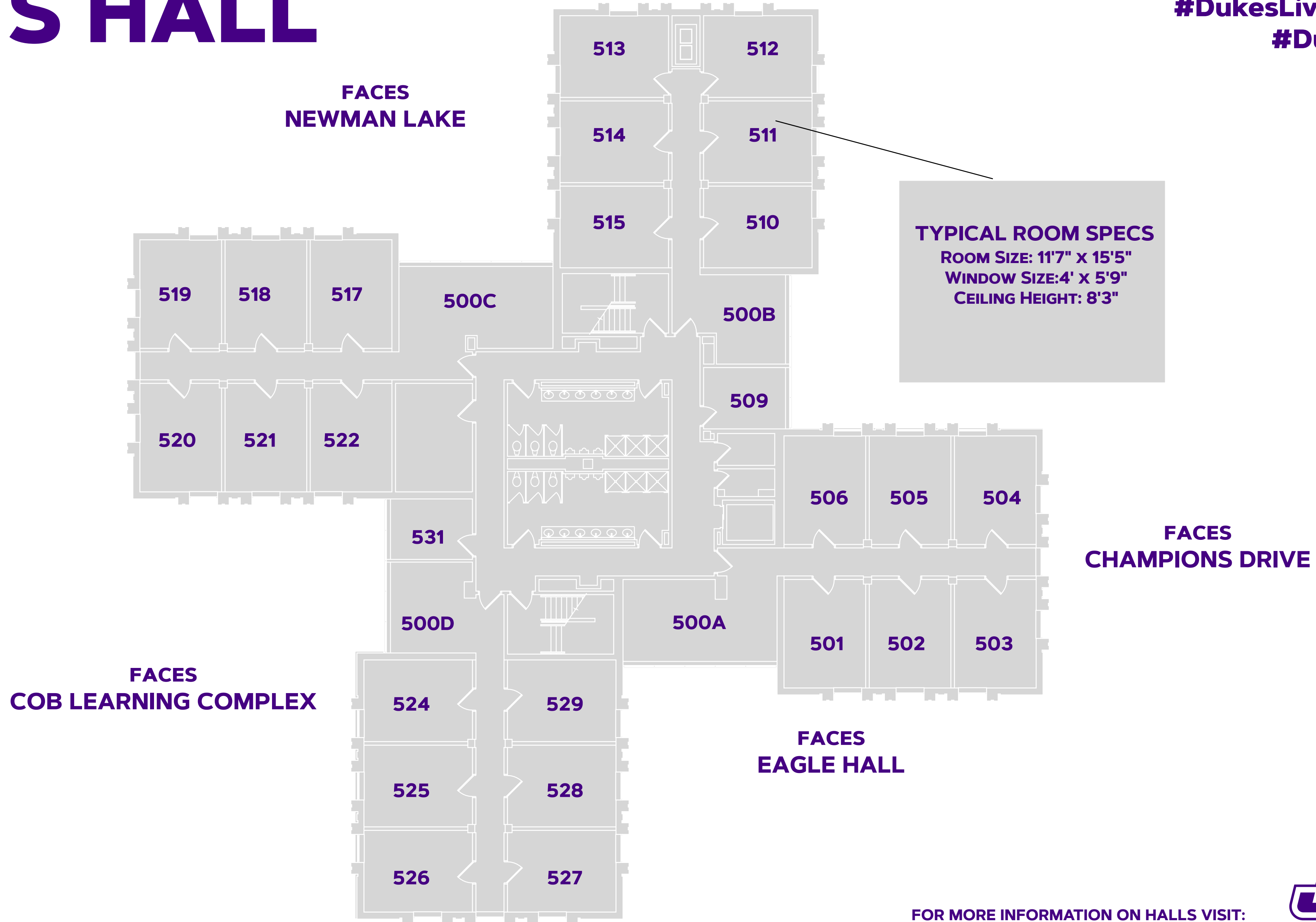

ROOM FURNITURE:
- BEDS, CHAIRS, DESKS, DRAWERS
- BUILT-IN WARDROBES

FOR MORE INFORMATION ON HALLS VISIT:
WWW.JMU.EDU/ORL/OUR-RESIDENCE-HALLS/INDEX.SHTML

