

HOFFMAN HALL

FIRST FLOOR

#DukesLiveClose
#DukesLiveSupported
#DukesLIVEON

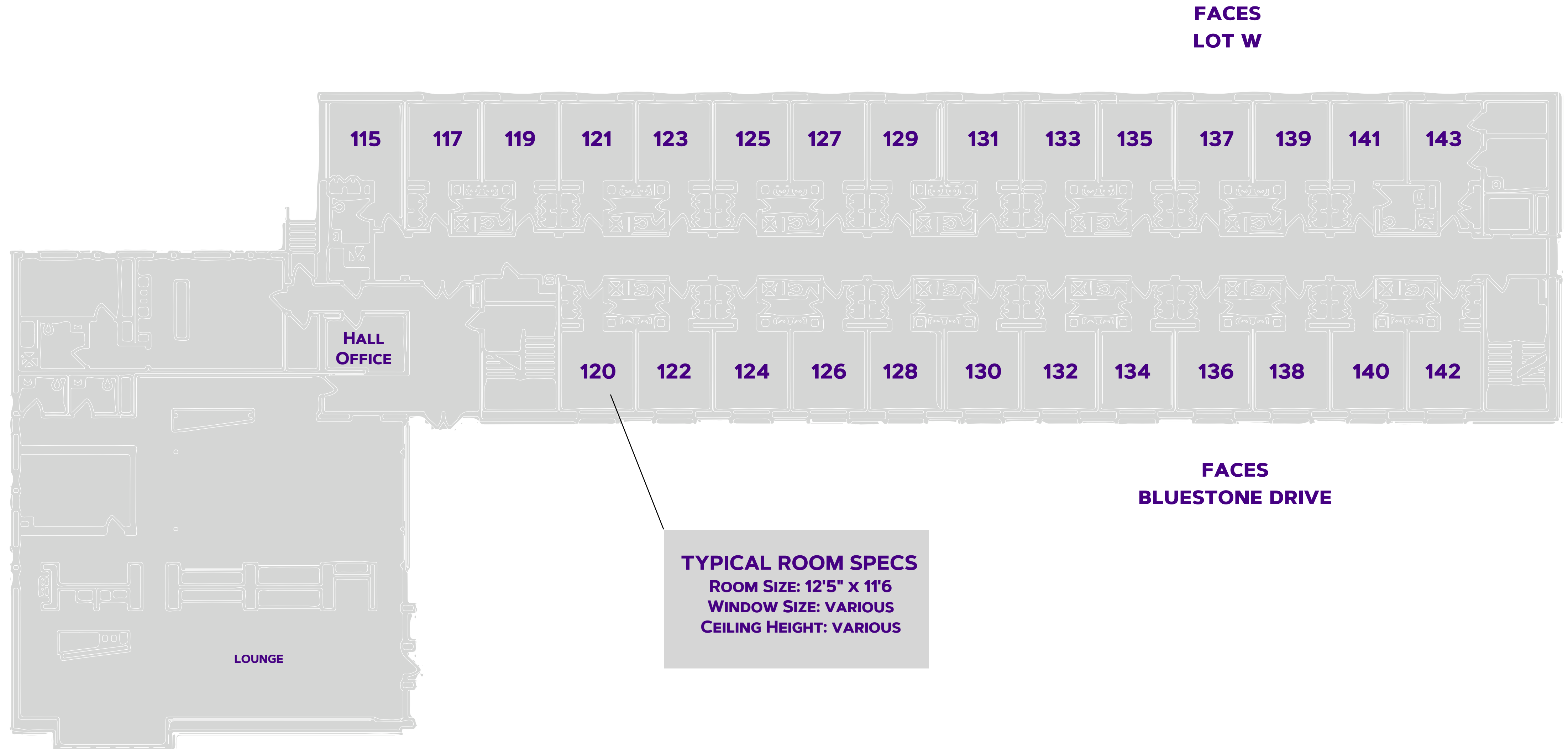

FACES
LOT W

FACES
BLUESTONE DRIVE

TYPICAL ROOM SPECS
ROOM SIZE: 12'5" X 11'6"
WINDOW SIZE: VARIOUS
CEILING HEIGHT: VARIOUS

ROOM FURNITURE:
- BEDS, CHAIRS, DESKS, DRAWERS
- BUILT-IN CLOSETS

FOR MORE INFORMATION ON HALLS VISIT:
WWW.JMU.EDU/URL/OUR-RESIDENCE-HALLS/INDEX.SHTML



HOFFMAN HALL

SECOND FLOOR

#DukesLiveClose
#DukesLiveSupported
#DukesLIVEON

FACES
LOT W

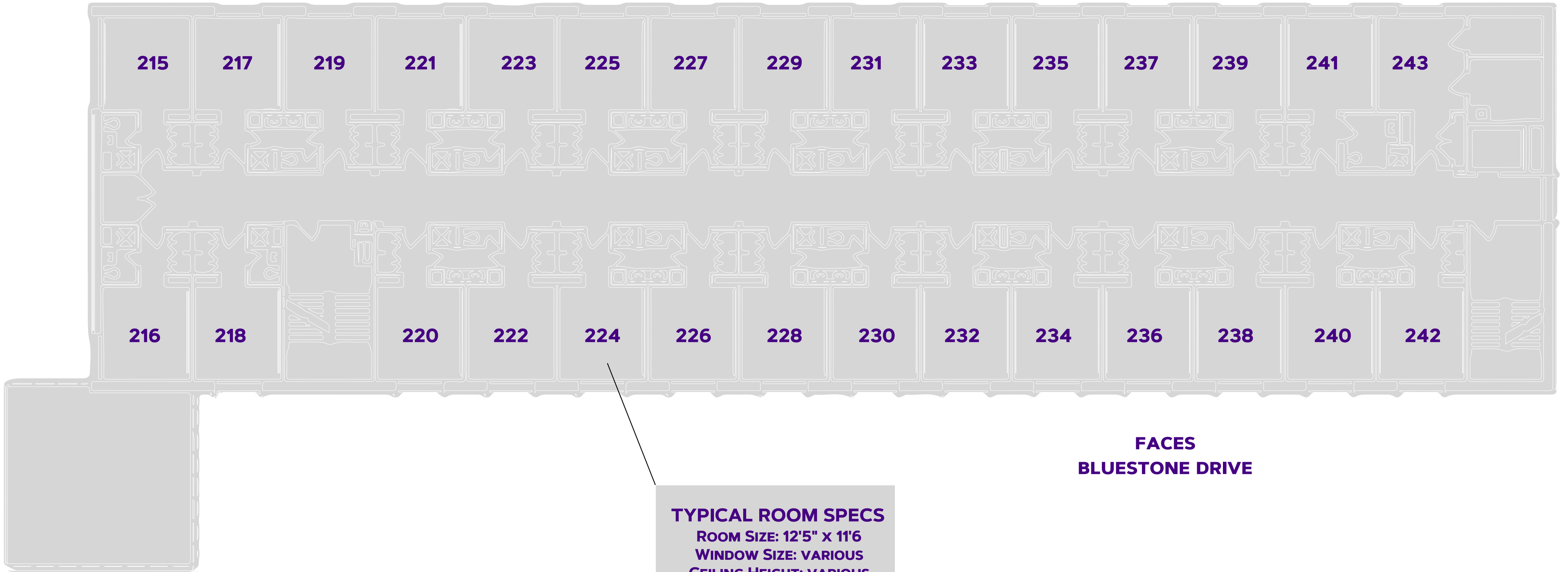

FACES
BLUESTONE DRIVE

TYPICAL ROOM SPECS
ROOM SIZE: 12'5" X 11'6"
WINDOW SIZE: VARIOUS
CEILING HEIGHT: VARIOUS

ROOM FURNITURE:
- BEDS, CHAIRS, DESKS, DRAWERS
- BUILT-IN CLOSETS

FOR MORE INFORMATION ON HALLS VISIT:
WWW.JMU.EDU/ORL/OUR-RESIDENCE-HALLS/INDEX.SHTML



HOFFMAN HALL

THIRD FLOOR

#DukesLiveClose
#DukesLiveSupported
#DukesLIVEON

FACES
LOT W

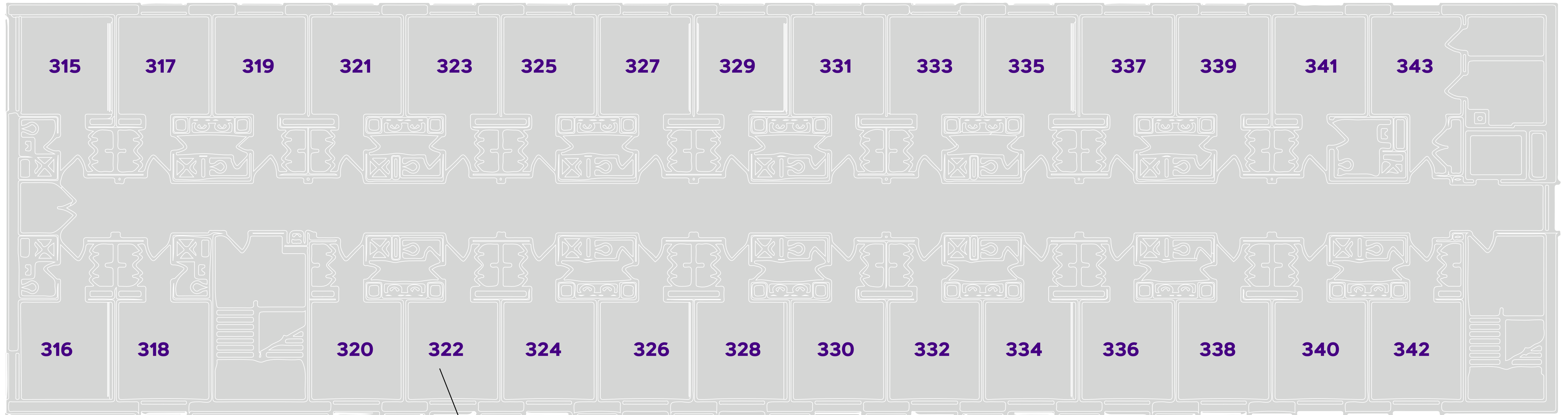

FACES
BLUESTONE DRIVE

TYPICAL ROOM SPECS

ROOM SIZE: 12'5" x 11'6"
WINDOW SIZE: VARIOUS
CEILING HEIGHT: VARIOUS

ROOM FURNITURE:
- BEDS, CHAIRS, DESKS, DRAWERS
- BUILT-IN CLOSETS

FOR MORE INFORMATION ON HALLS VISIT:
WWW.JMU.EDU/ORL/OUR-RESIDENCE-HALLS/INDEX.SHTML

